

Single (CDX) impeller centrifugal pumps with hydraulic components constructed in stainless steel AISI 304, suitable for pressure boosting, water supply, water treatment and irrigation. Air conditioning systems and general water pumping including moderately aggressive liquids



SPECIFICATIONS

- Max working pressure: 8 bar
- Max. water temperature: 60°C CDX 70
90°C
110°C CDXH - CDXHS

MATERIALS

- Pump body, impeller, diffuser and casing cover in AISI 304
- Shaft in AISI 303
- Bracket and motor casing in aluminium
- Mechanical seal in carbon/ceramic/NBR
- Special mechanical seal are available on demand

TECHNICAL DATA

- T.E.F.C. 2 poles motor
- Insulation class F
- Protection degree IP 55
- Single-phase standard voltage: 220-230V $\pm 6\%$
- Three-phase standard voltage: 220/380V -6% +10%
- Permanent split capacitor and automatic thermal overload protection for single-phase version
- Thermal protection to be provided by the user for three-phase version
- DNA from 1³/₄ to 1¹/₂
- DNM 1"

DIMENSIONS

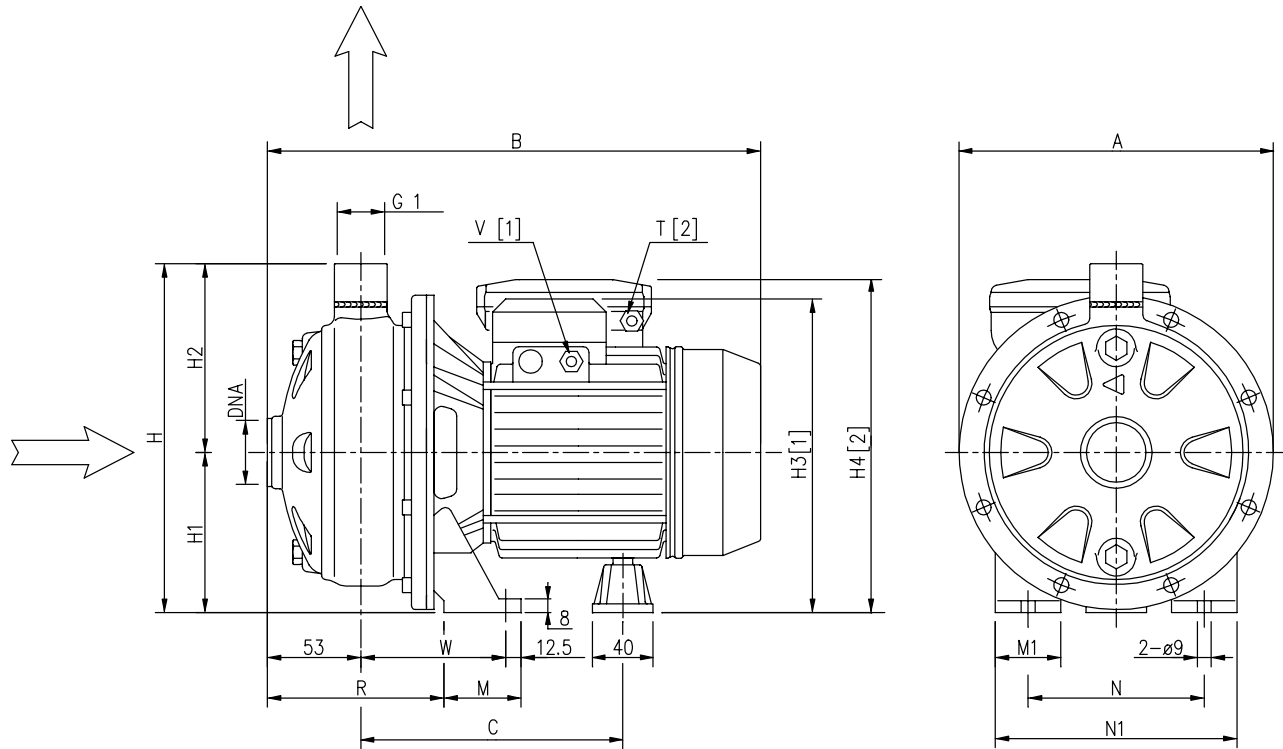

DIMENSIONAL TABLE

Pump type CDX(M)	Dimensions [mm]																		Weight [kg]	
	A	B		C	H	H1	H2	H3	H4	M	M1	N	N1	R	T	V	W	DNA	1~	3~
		[1]	[2]																	
70/076	208	321,5	321,5	181	229,5	106	123,5	207	211	50	38	120	160	108	PG 11	PG 11	92,5	G 1 1/4	9,5	9
70/106	208	321,5	321,5	181	229,5	106	123,5	207	211	50	38	120	160	108	PG 11	PG 11	92,5	G 1 1/4	10,5	10
70/156	208	321,5	321,5	181	229,5	106	123,5	207	211	50	38	120	160	108	PG 11	PG 11	92,5	G 1 1/4	13,7	13,7
120/106	208	321,5	321,5	181	229,5	106	123,5	207	211	50	38	120	160	108	PG 11	PG 11	92,5	G 1 1/4	10,5	10
120/156	208	321,5	321,5	181	229,5	106	123,5	207	211	50	38	120	160	108	PG 11	PG 11	92,5	G 1 1/4	12	12
120/206	208	346	359	199,5	229,5	106	123,5	221,5	242,5	55	40	140	180	105,5	PG 13.5	PG 11	95	G 1 1/4	16,5	15
200/156	208	321,5	321,5	181	229,5	106	123,5	207	211	50	38	120	160	108	PG 11	PG 11	92,5	G 1 1/2	12	11,5
200/206	208	346	359	199,5	229,5	106	123,5	221,5	242,5	55	40	140	180	105,5	PG 13.5	PG 11	95	G 1 1/2	15,5	15
200/306	232	359	-	199,5	250	118	132	233,5	-	55	40	140	180	105,5	-	PG 11	95	G 1 1/2	-	16,5

[1] = Only for threephase
[2] = Only for singlephase

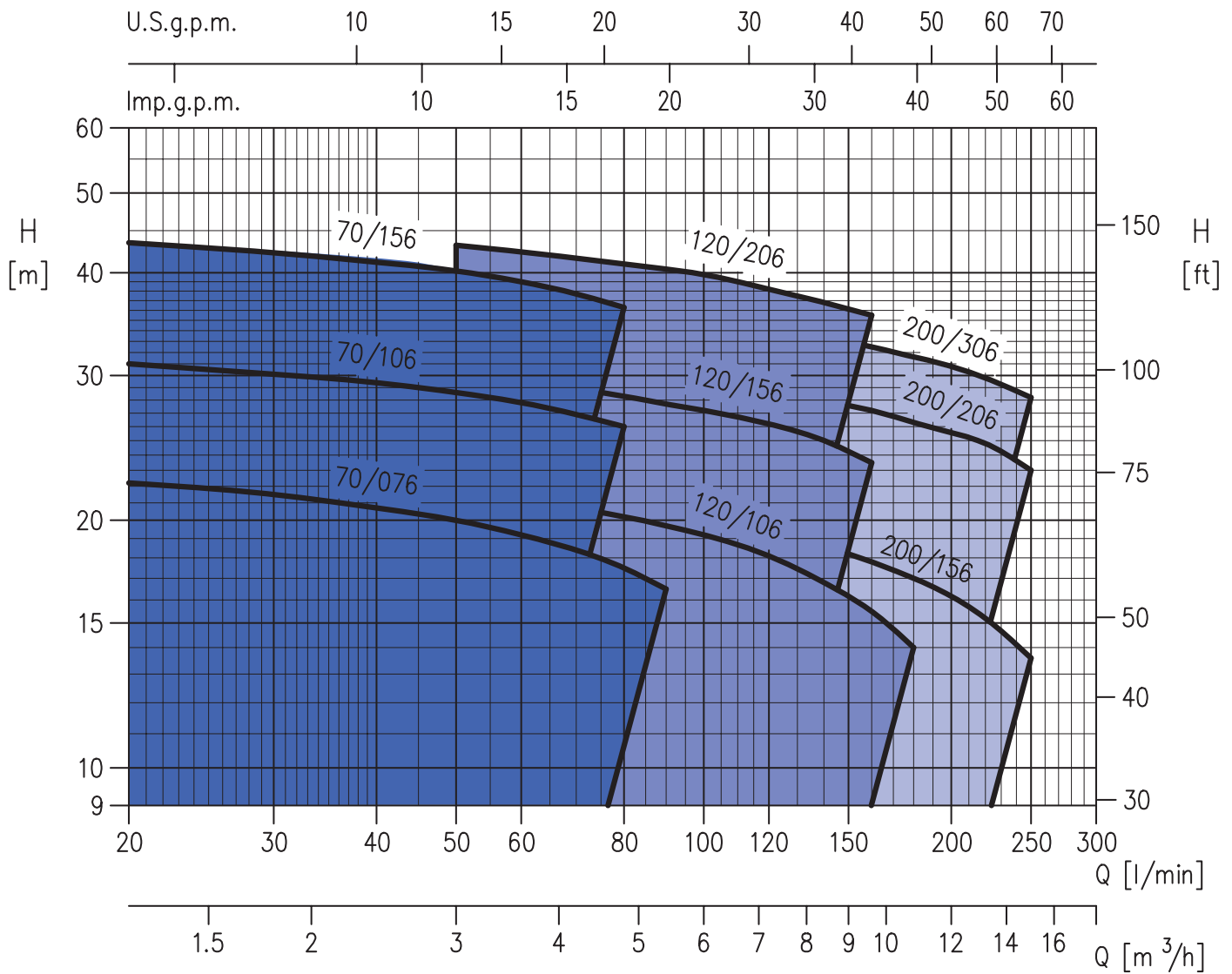
PERFORMANCE CHART CDX (according to ISO 9906 Annex A)

PERFORMANCE TABLE

Pump type		Output		Absorbed current [A]			Q=Capacity											
							H=Total manometric head in meters											
Single-Phase	Three-Phase	kW	HP	Single-phase	Three-phase		l/min	20	50	80	90	120	140	160	180	220	250	
					220V	380V	m³/h	0	1.2	3	4.8	5.4	7.2	8.4	9.6	10.8	13.2	15
CDXM 70/076	CDX 70/076	0,55	0,75	3,4	2	1,2	23,5	22,2	20	17,5	16,5	-	-	-	-	-	-	
CDXM 70/106	CDX 70/106	0,75	1	5,1	2,9	1,7	32,3	31	28,6	26	-	-	-	-	-	-	-	
CDXM 70/156	CDX 70/156	1,1	1,5	7,5	4,5	2,6	44,5	43,5	40,2	36,3	-	-	-	-	-	-	-	
CDXM 120/106	CDX 120/106	0,75	1	5,2	2,9	1,7	23,8	-	21,8	20,2	19,7	18,1	16,8	15,5	14	-	-	
CDXM 120/156	CDX 120/156	1,1	1,5	7,2	4,3	2,5	32	-	29,8	28,3	27,7	26,2	25	23,5	-	-	-	
CDXM 120/206	CDX 120/206	1,5	2	11,3	6,9	4	45,5	-	43,2	41	40,4	38,2	36,8	34,5	-	-	-	
CDXM 200/156	CDX 200/156	1,1	1,5	6,6	3,9	2,3	28,3	-	-	20,8	20,4	19,4	18,6	17,8	17	15,2	13,5	
CDXM 200/206	CDX 200/206	1,5	2	10	6,2	3,6	32	-	-	30	29,5	28,6	27,9	27,2	26,3	24,6	23	
-	CDX 200/306	2,2	3	-	8,2	4,7	38,8	-	-	35,5	35,1	34	33,3	32,5	31,6	29,8	28,3	

PERFORMANCE CURVES CDX 70 series (according to ISO 9906 Annex A)

CDX 70/076 (0.55 kW) - Impeller diameter = 115 mm

CDX 70/106 (0.75 kW) - Impeller diameter = 132 mm

CDX 70/156 (1.10 kW) - Impeller diameter = 157 mm

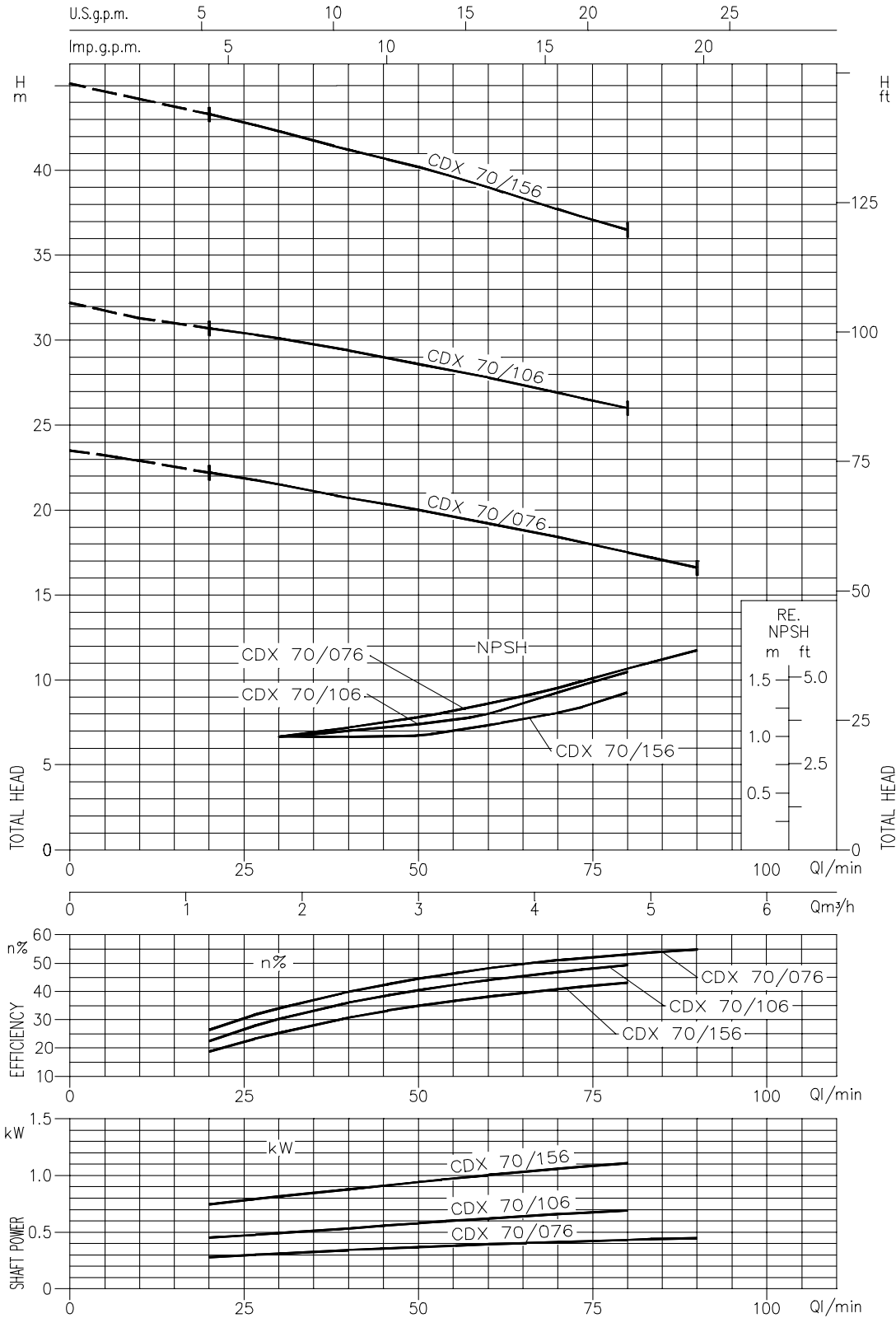

PERFORMANCE CURVES CDX 120 series (according to ISO 9906 Annex A)

CDX 120/106 (0.75 kW) - Impeller diameter = 115 mm

CDX 120/156 (1.10 kW) - Impeller diameter = 132 mm

CDX 120/206 (1.50 kW) - Impeller diameter = 157 mm

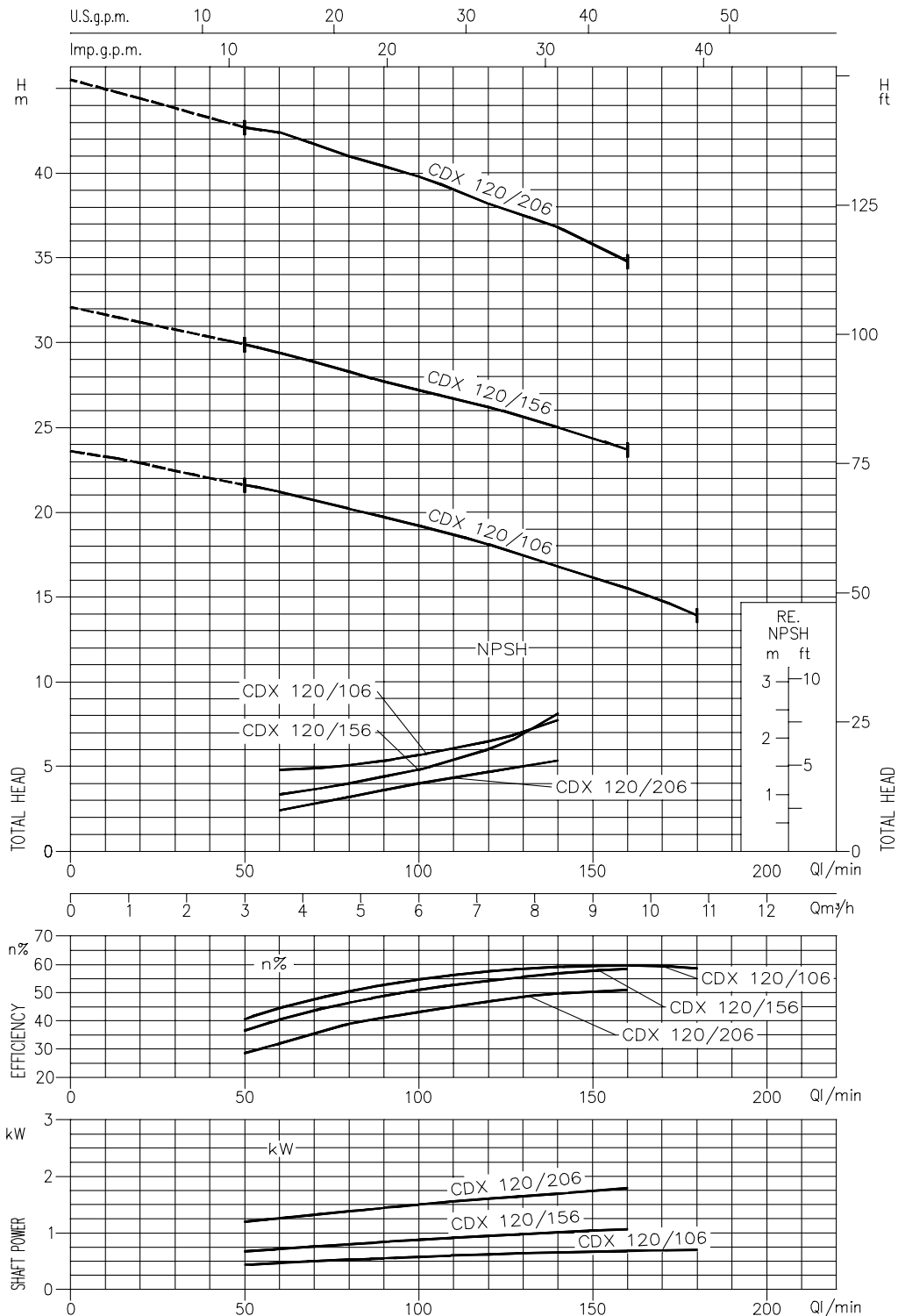

PERFORMANCE CURVES CDX 200 series (according to ISO 9906 Annex A)

CDX 200/156 (1.1 kW) - Impeller diameter = 115 mm

CDX 200/206 (1.5 kW) - Impeller diameter = 132 mm

CDX 200/306 (2.2 kW) - Impeller diameter = 144 mm

